

Rolife

Leisure Time

SN001

ANCIENT
HOUSE CHINA

One thousand years in a blink,
dream back to the great dynasties.



Brief Introduction

Tips of Glue(The picture is only for reference.)

- 1.Liquid glue is used to glue large wood parts and other materials.
- 2.Do not use too much glue in case of longer time to dry.
It may also affect the outward appearance of completed products.



Liquid Glue

Tips of Assembling

1. Small parts are included. Children must assemble under the guidance of adults in case of swallowing by mistake.
2. Put the remains back to original bags after taking enough dosage in each step till completed.(In case of missing materials.)
3. All the dimension in the instruction is shown in millimeter (mm).
4. Find the part you need according to material list and the 1:1 part illustration paper.(Only for wood parts.)
Check its number and size carefully before assembling.See Part Number Explanation at the end of this page.

Tool Included

1



Tweezers(Bag No.5)

2

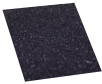

Sandpaper(Bag No.1)

1



Ruler

2



Scissors

3



Utility knife

4



Needle-nose pliers

5



Needle

6



Cutting pliers

7



Black pen

Tool Excluded

Tips of the golden card paper and the wood paper

- 1.Cut the golden card paper and the wood paper according to the instruction.

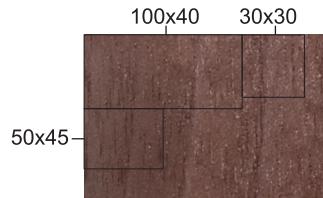
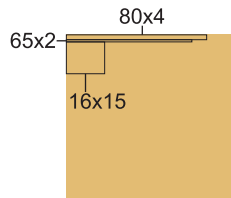

1

Find the part illustration paper which placed separately in the box.

2

Compare the part with the illustration paper to find the part number.

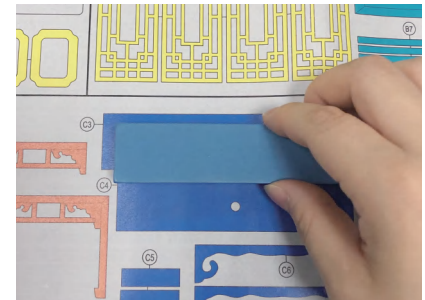

Part number explanation

- 1- C9 is in Bag No.1,the number of the part is C9.(Only note the part number in the steps.)

Square table

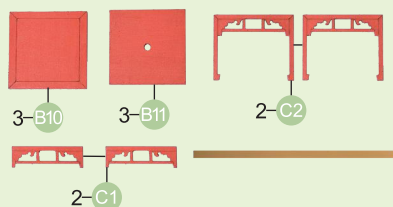

Material List

- ① Wood pieces 6 pcs
- ② Golden card paper 80x4mm 1 pc (Bag No.1)

1

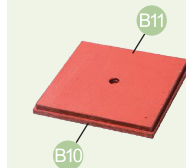

Glue as shown.

2



Glue as shown and align with the edge of the table.

3



Glue as shown.

4

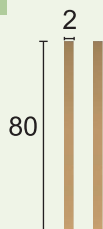

Cut as shown.

5



Trim as shown.

6



Glue and complete.

Long table

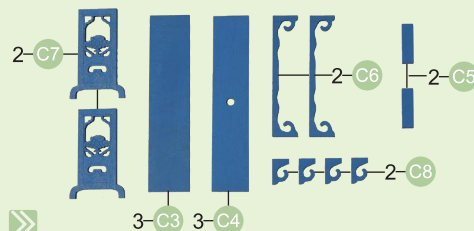

Material List

- ① Wood pieces 12 pcs

1

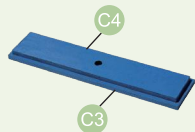

Glue as shown.

2

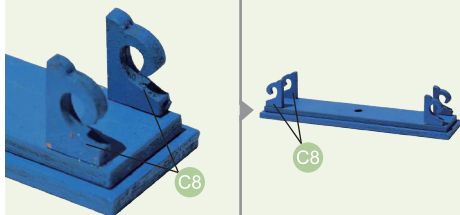

Glue as shown.

3



Glue as shown.



Glue as shown.



Completed.

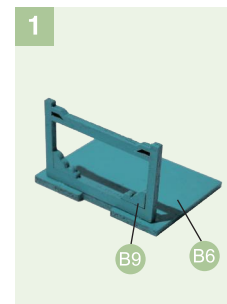
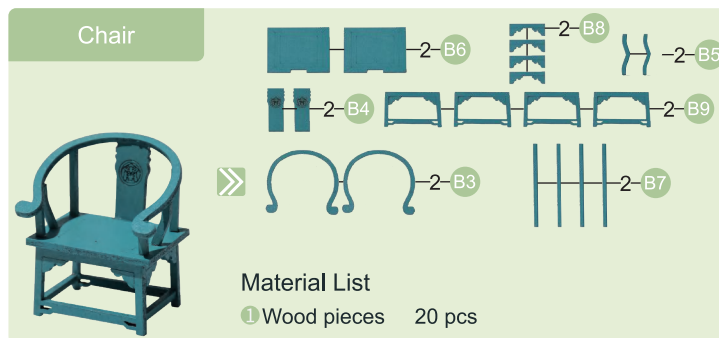

Glue as shown.

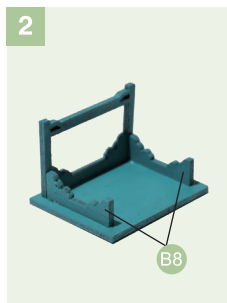

Glue as shown.

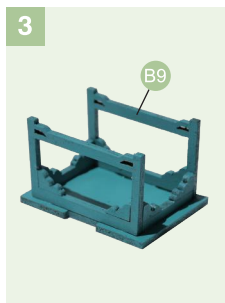

Glue as shown.

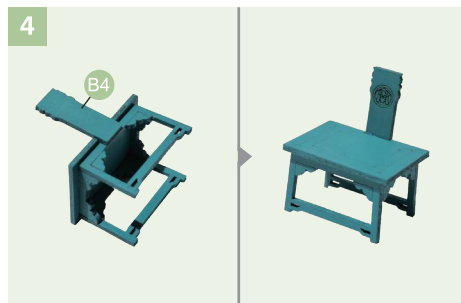

Slope and glue as shown.



Cut with the utility knife as shown.

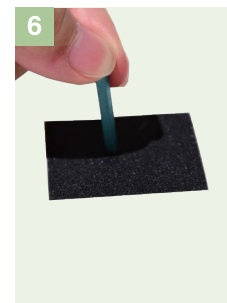

Grind the cutting surface with the sandpaper to make it flat.

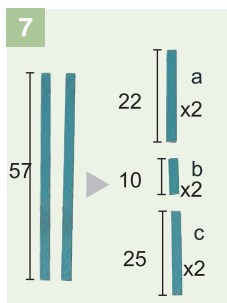

Cut as shown.



Glue as shown.

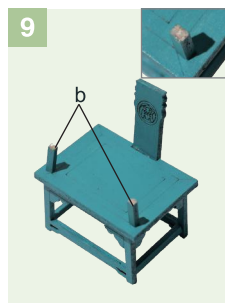

Glue as shown.



Glue as shown.

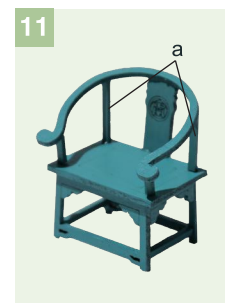

Glue as shown.

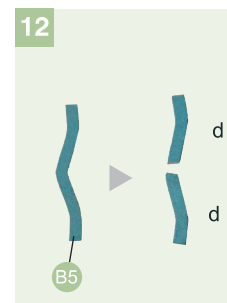

Cut in the middle.



Glue as shown.

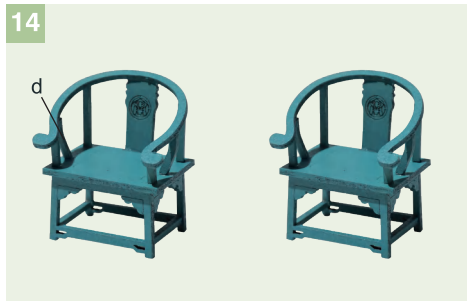

Complete 2 chairs.

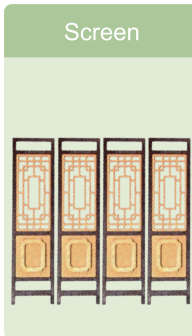

Screen

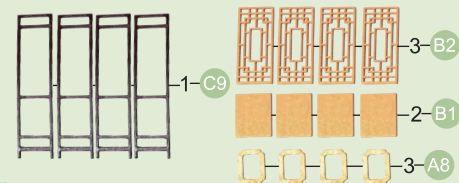

Material List

- ① Wood pieces 16 pcs
- ② Translucent paper 2pcs(Bag No.1)

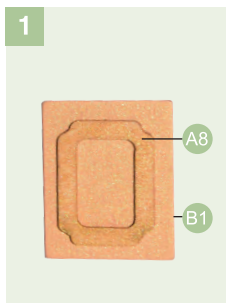

Glue as shown.

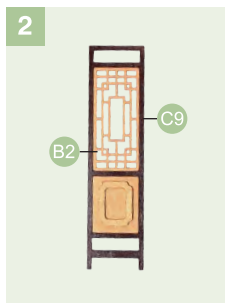

Glue as shown.

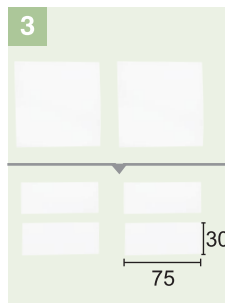

Cut the translucent paper as shown.

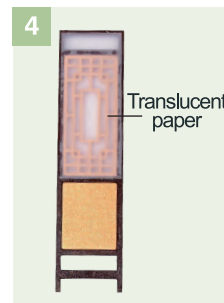

Glue as shown.



Complete four.

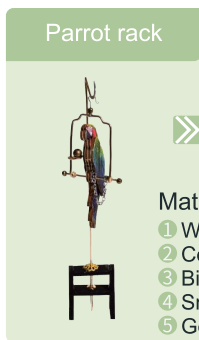

Parrot rack

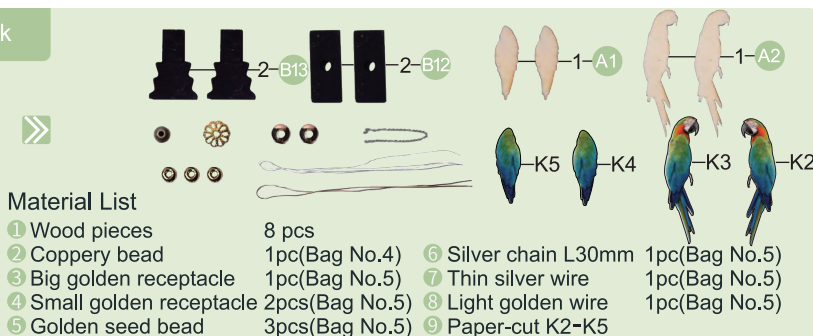

Material List

- ① Wood pieces 8 pcs
- ② Coppery bead 1pc(Bag No.4)
- ③ Big golden receptacle 1pc(Bag No.5)
- ④ Small golden receptacle 2pcs(Bag No.5)
- ⑤ Golden seed bead 3pcs(Bag No.5)
- ⑥ Silver chain L30mm 1pc(Bag No.5)
- ⑦ Thin silver wire 1pc(Bag No.5)
- ⑧ Light golden wire 1pc(Bag No.5)
- ⑨ Paper-cut K2-K5

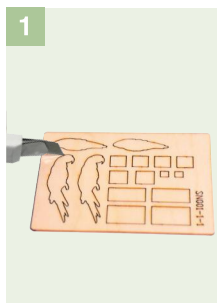

Remove the wood part with the utility knife.



Grind the edge to make it better.



Glue as shown.

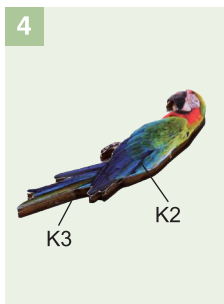

Glue as shown.

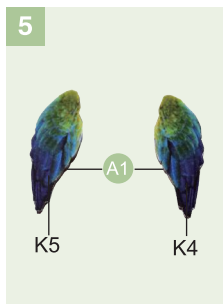

Glue as shown.

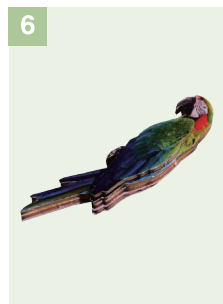

Glue as shown.



Completed.

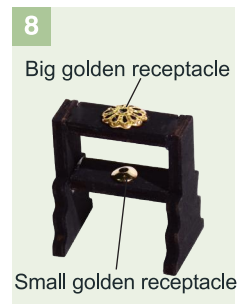

Glue as shown.

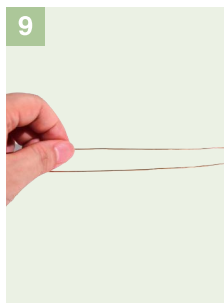

Straighten up the light golden wire.

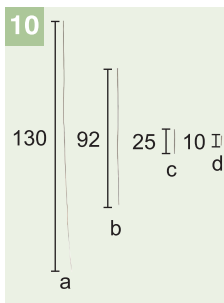

Cut as shown.

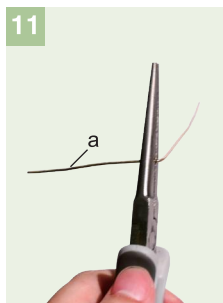

Bend with the pliers.

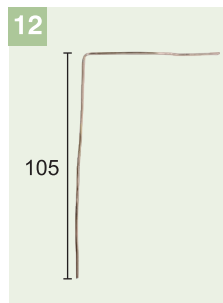

Bend as shown.

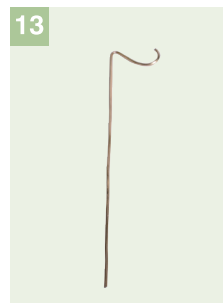

Bend as shown.

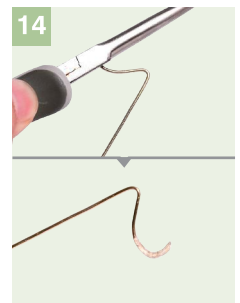

Press the part as shown.



Insert into the hole and glue.

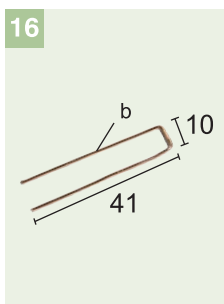

Bend as shown.

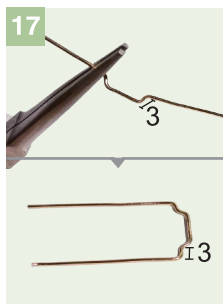

Bend as shown.

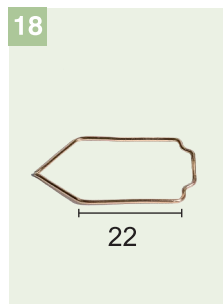

Bend as shown.

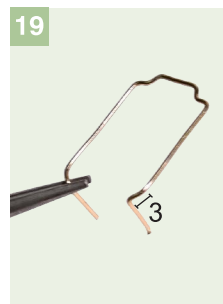

Bend as shown.

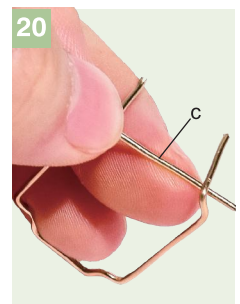

Put as shown.

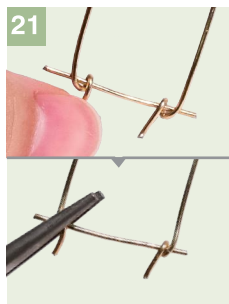

Wrap as shown and clamp with pliers.

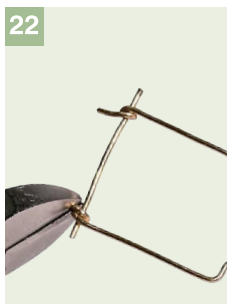

Cut the excessive part.



Completed.

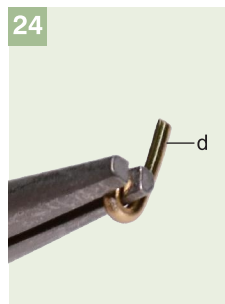

Bend as shown.

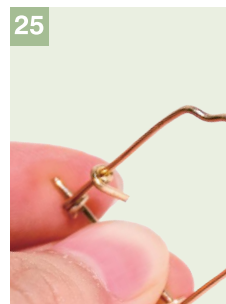

Put as shown and clamp with pliers.

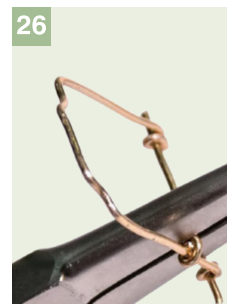

Clamp flat with pliers.



Clamp flat and complete as shown.

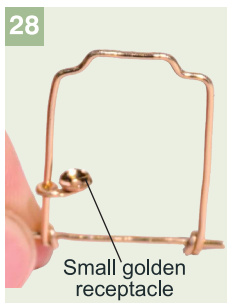

Glue as shown.

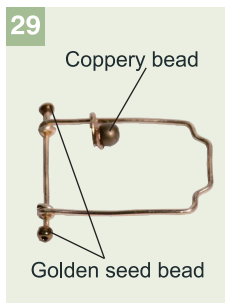

Glue as shown.



Wrap the iron wire as shown.

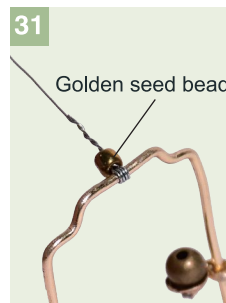

Go through the golden seed bead and fix it as shown.

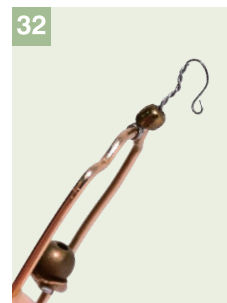

Adjust the shape and cut the excessive wire.

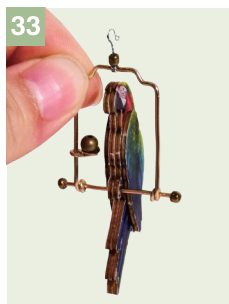

Glue the parrot on the rack as shown.

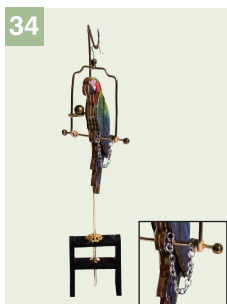

Glue the silver chain on the foot of the parrot and complete as shown.

Scroll

Material List

- ① Brown thin thread L900mm
- ② White pot
- ③ Coffee wooden bead
- ④ Golden card paper 65x2mm
- ⑤ Toothpick
- ⑥ Paper-cut K6-K8

1pc(Bag No.4)

1pc(Bag No.4)

6pcs(Bag No.4)

1pc(Bag No.1)

3pcs(Bag No.5)



Glue the golden card paper as shown.



Roll with the toothpick.

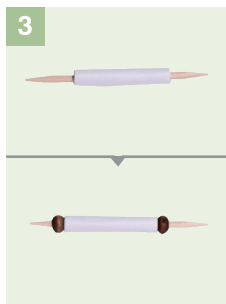

Put 2 wooden beads on both sides of the toothpick and fix them.

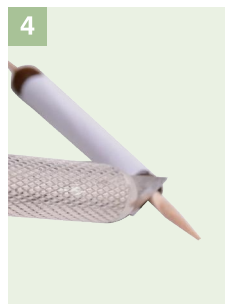

Cut the excessive toothpick.

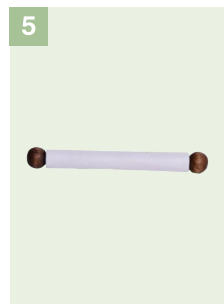

Complete the scroll.

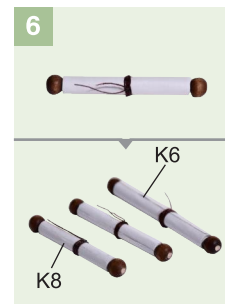

Wrap the scroll with the thin thread(L300mm) and complete three.

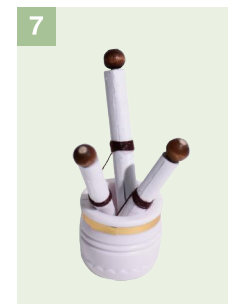

Completed.

Kite

Material List

- ① Paper-cut K18
- ② Light golden wire L120mm 1pc(Bag No.5)

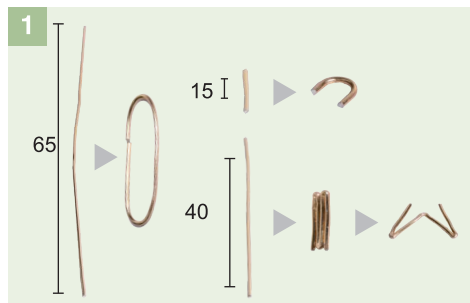

Cut and bend as shown.



Glue as shown.

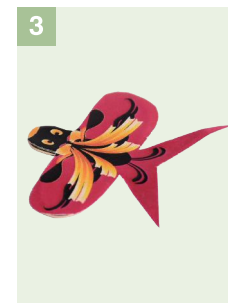

Completed.

Rattle-drum

Material List

- ① Red clay (Bag No.4)
- ② Coffee thread L80mm 1pc(Bag No.4)
- ③ Dark golden wire L44mm 1pc(Bag No.5)
- ④ Golden seed bead 2pcs(Bag No.5)
- ⑤ Light-colour cloth 1pc(Bag No.1)

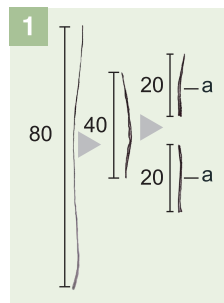

Cut the thread to make two a and glue each colse together.

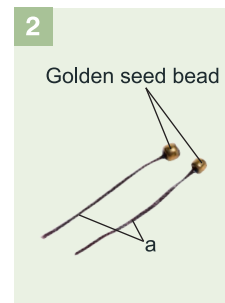

Insert the thread into the seed bead and glue.

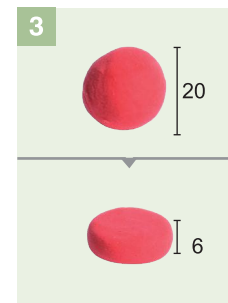

Take some clay and rub it into a ball and then flatten it.(Seal the remaining clay and lay aside.)

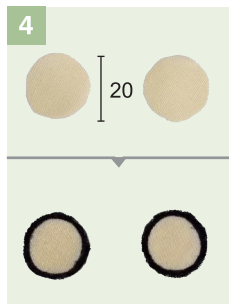

Cut 2 circles with a diameter of 20mm, and paint them black as shown.



Glue in the middle.



Glue the other one.

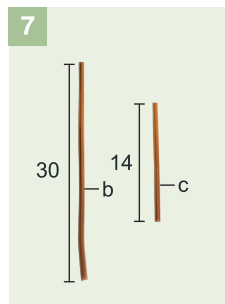

Cut as shown.



Insert into the clay.

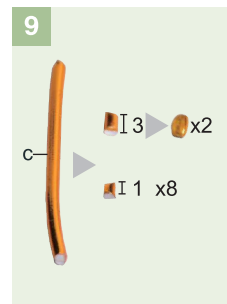

Cut as shown. Clamp the 3mm wire with the pliers and complete two.

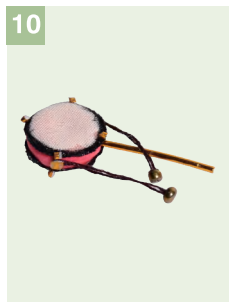

Glue as shown.
Completed.



Glue as shown.

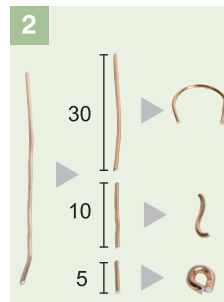

Cut and bend as shown.

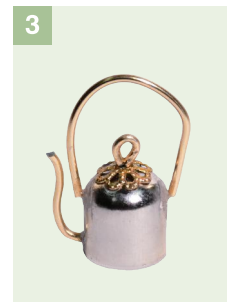

Glue as shown.
Completed.

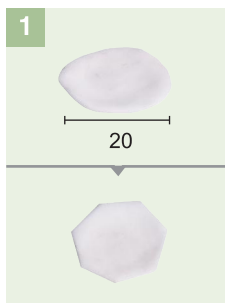

Take some white clay, rub it into an oblate slice and trim as shown.

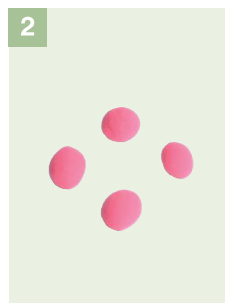

Mix some red clay with white clay and rub it into 4 balls.(5mm in diameter)

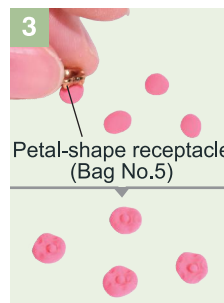

Press out the shape with the receptacle after dried.



Put as shown and complete.

Cage



Material List

- | | |
|----------------------------|----------------|
| ① Wood pieces | 3 pcs |
| ② Wood-grain paper 30x30mm | 1pc (Bag No.1) |
| ③ Golden seed bead | 1pc (Bag No.5) |
| ④ Dark golden wire L66mm | 1pc (Bag No.5) |

1

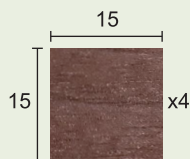

Cut the wood-grain paper.

2

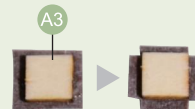

Glue in the middle and trim as shown.

3



Glue and trim as shown.

4

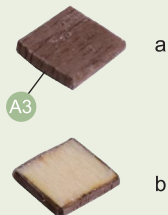

Complete two and glue the wood-grain paper on the bottom of b.

5



Glue and trim as shown.

6

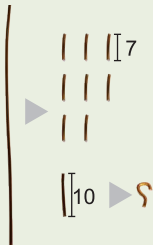

Cut and bend as shown.

7



Glue as shown.

8



Glue as shown.

9



Glue as shown.

10



Glue as shown.

11



Glue as shown.
Completed.

Envelope

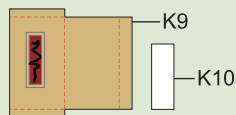

Material List

- ① Paper-cut K9-K10

1



Glue as shown.

2



Cut as shown.



Fold and insert.
Completed.

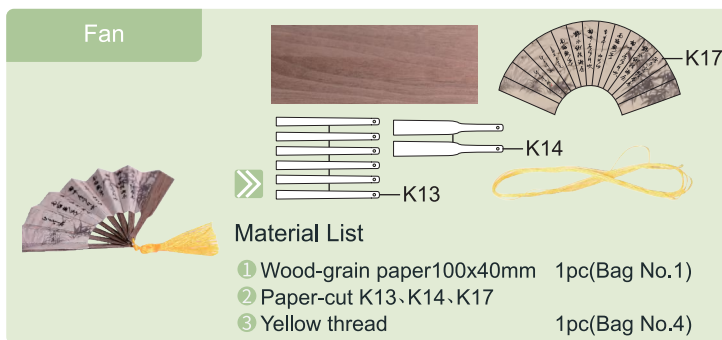

Fold as shown.

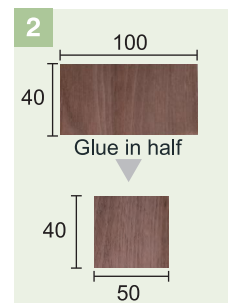

Glue in half as shown.



Cut according to K13.
(Pay attention to the pattern
of wood-grain paper
parallel with the long side.)



Trim as shown.

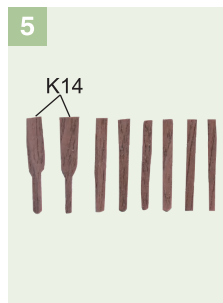

Complete eight.

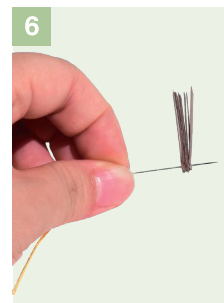

Insert the 8 ribs of the fan
with a needle threaded
by a yellow thread.
(L100mm)

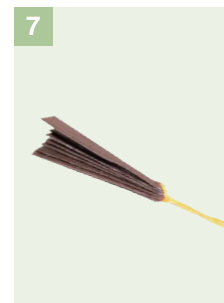

Tighten up and
tie a knot.

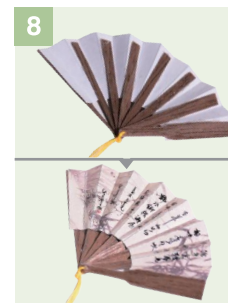

Glue the sector.

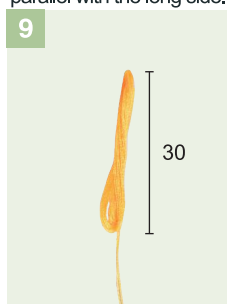

Fold the thread
(L600mm) in half.

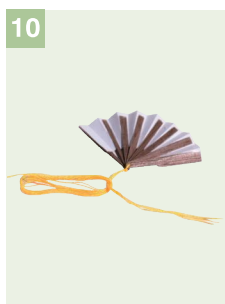

Insert into the fold
as shown.



Tighten up and
tie a knot.



Wrap as shown.

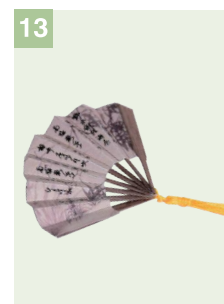

Tie a knot.

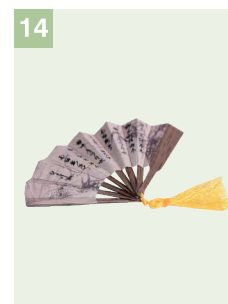

Trim and complete.

Treasure box



Material List

- 1 Wood pieces 6 pcs
- 2 Dark golden wire L20mm 1pc(Bag No.5)
- 3 Petal-shape receptacle 1pc(Bag No.5)
- 4 Triangular sequins (Bag No.4)
- 5 Broad flat wire L35mm 1pc(Bag No.5)
- 6 Golden card paper 16x15mm 1pc(Bag No.1)
- 7 Wood-grain paper 50x45mm 1pc(Bag No.1)
- 8 Paper-cut K19

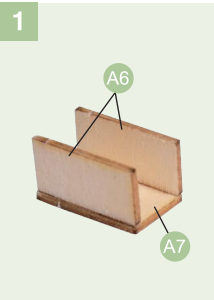
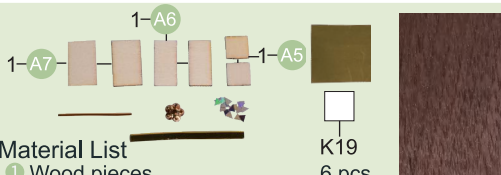

Glue as shown.



Glue as shown.

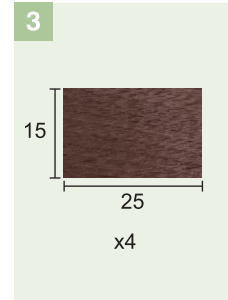

Cut as shown.



Glue in the middle and trim as shown.

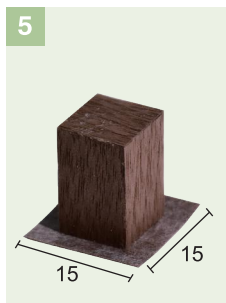

Glue the wood-grain paper and trim as shown.



Wrap with the wood-grain paper and complete as shown.

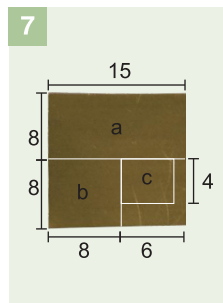

Cut the golden card paper.

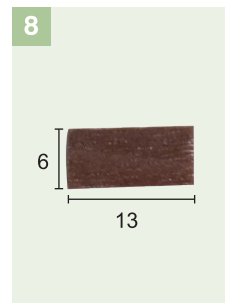

Cut the wood-grain paper.

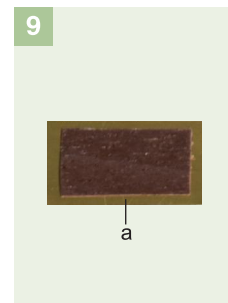

Glue in the middle as shown.



Glue as shown.



Glue the triangular sequins as shown.

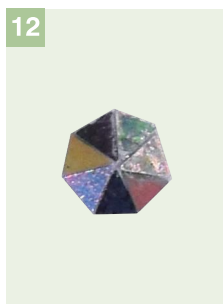

Trim the excessive white paper.



Glue as shown.

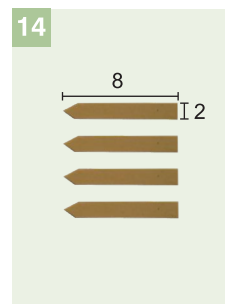

Trim b as shown.

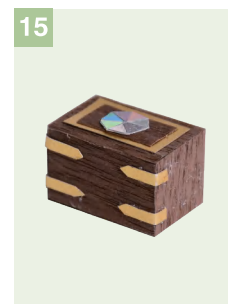

Glue as shown.

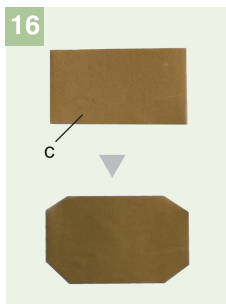

Trim as shown.

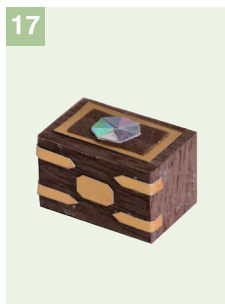

Glue as shown.

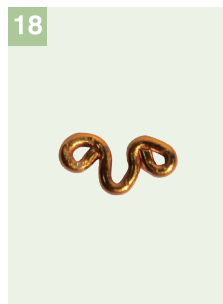

Bend with the pliers
as shown.



Glue as shown.

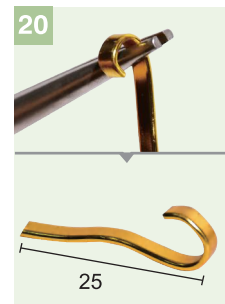

Bend with the pliers
as shown.

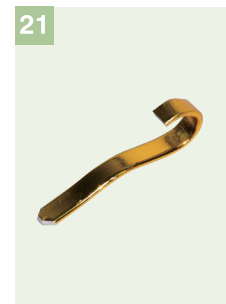

Trim to arc as shown.



Glue as shown.

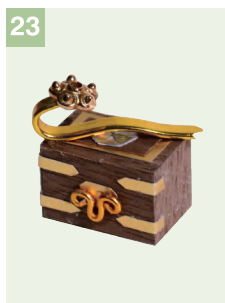

Glue as shown.
Completed.

Plant One

Material List

- ① Green stem 1pc(Bag No.5)
- ② Stamen 1pc(Bag No.4)
- ③ Flowerpot shape big seed bead 1pc(Bag No.4)
- ④ Paper-cut K15、K16

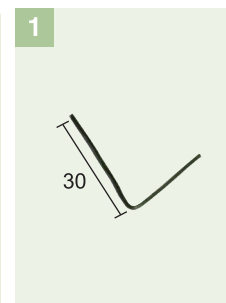

Bend the stem
as shown.

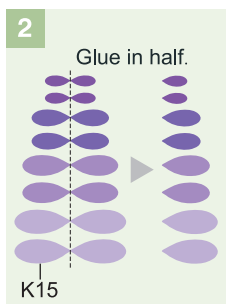

Glue in half and
trim as shown.

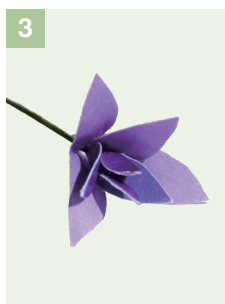

Bend the petal and
glue as shown.

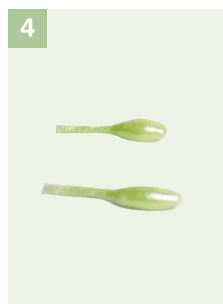

Trim the stamen.

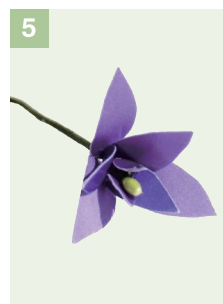

Glue the stamen.



Bend the leaf and
glue as shown.

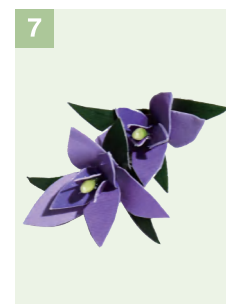

Complete another one.

8

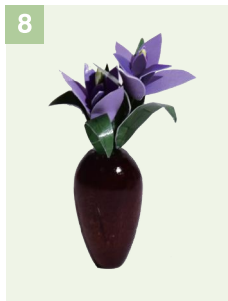

Insert into the hole of the wooden bead and glue to fix it.

Plant Two



Material List

- ① White clay (Bag No.4)
- ② Red clay (Bag No.4)
- ③ Paper-cut K11·K12



K11

K12

1



Take some white clay to roll into a ball. (20mm in diameter.)

2



Shape a bowl and glue a litter.

3

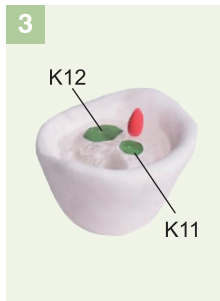

Put the paper-cut on the glue with the tweezers and take some red clay to roll into an oblong to put on it.

Small Components (Place them at will.)

A

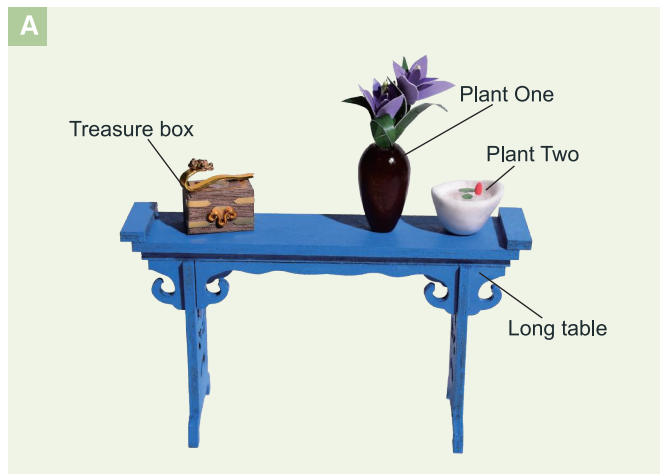

B



Sequence of Assembly

1

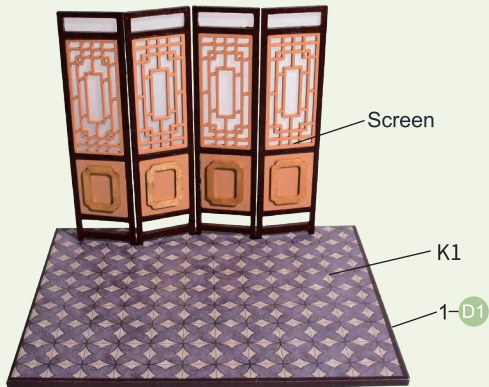

2

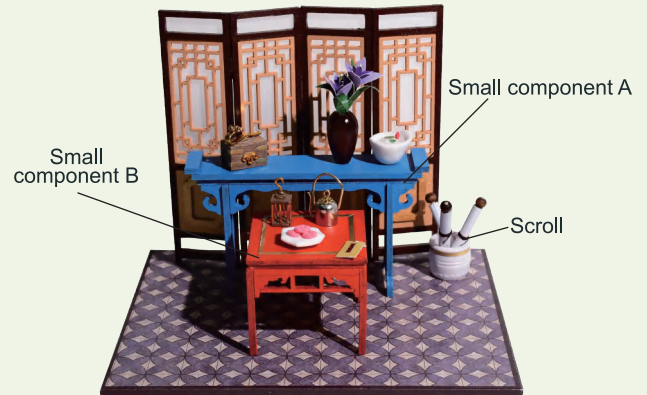

3





Rolife Official Facebook Page

Trends, Events, Interactivity, Group.

[Discover more collection.](#)

Have more fun here.



Rolife Official Website

News, Discover, Fun, Store.

[Discover more collection.](#)

Find more products here.

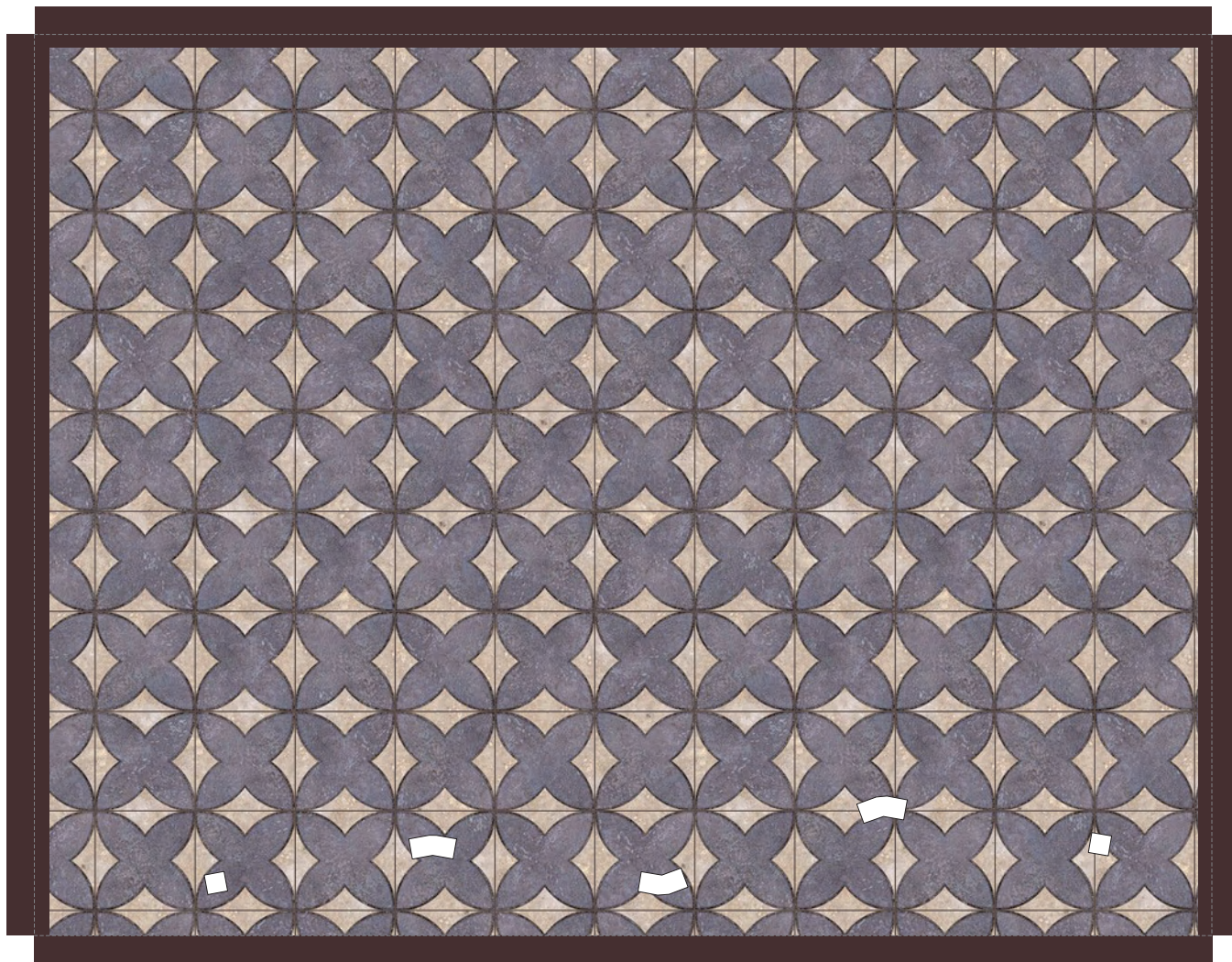

K1

K2

K3

K4

K5



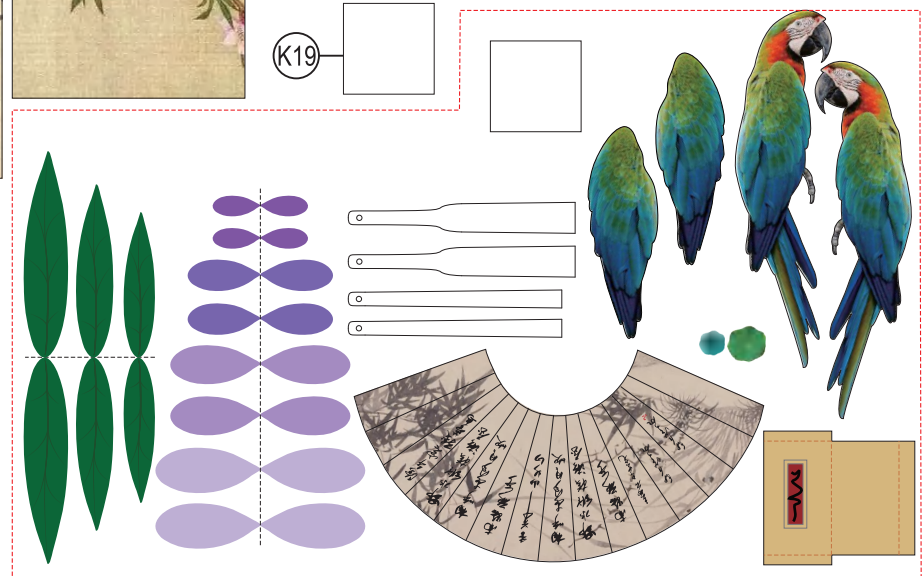
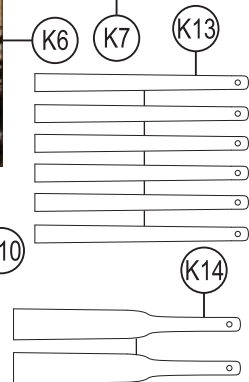
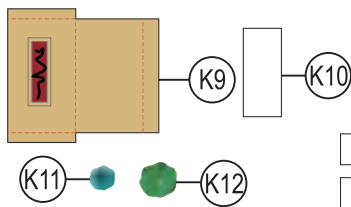
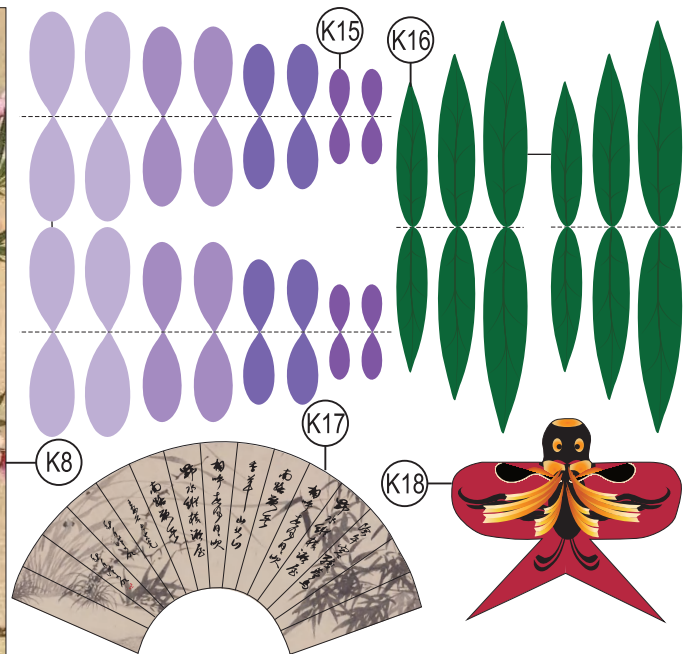
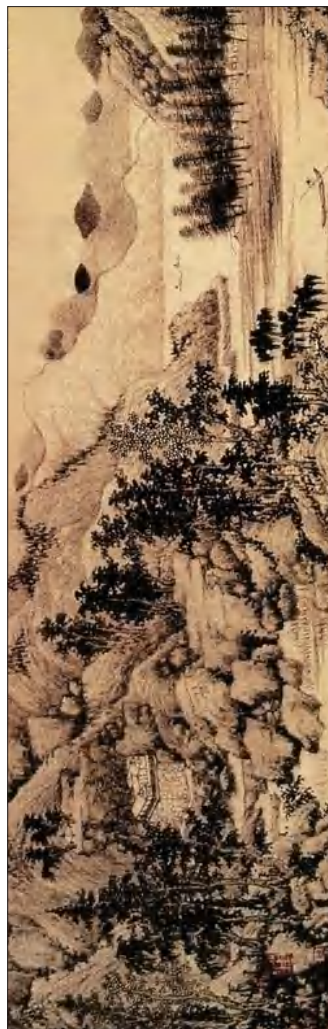

Part C-3mm (C9)

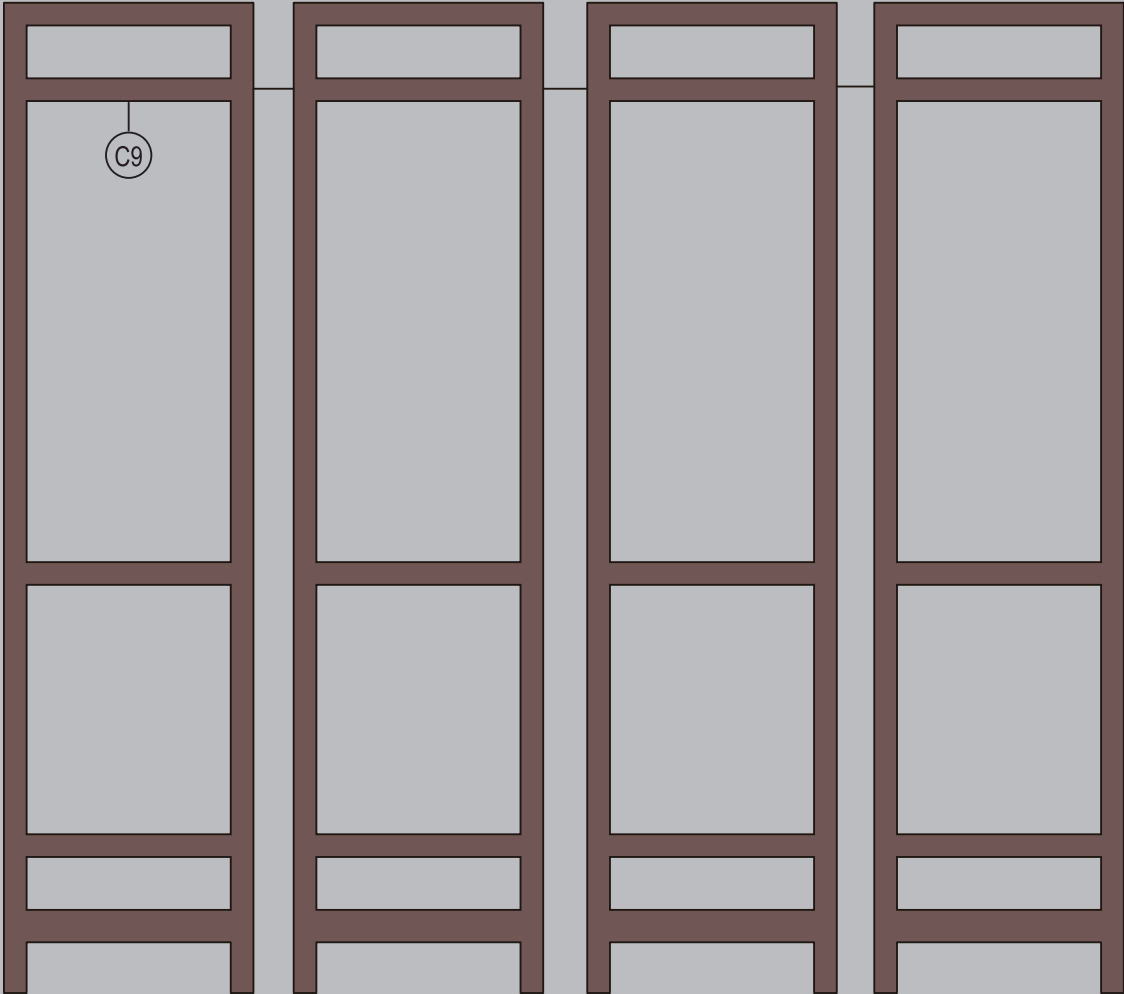

Part D-4mm (D1)

